

SUDAFED®

BLOCKED NOSE

Spray

Xylometazoline hydrochloride

- This medicine is used to help clear the stuffy, blocked up feeling in your nose and sinuses caused by colds and allergies such as hay fever.
- This medicine is for use by adults and children aged 12 years and over.
- **Do not take this medicine:**
 - There are some people who should not take this medicine. *To find out if you are one of them see section 2 ▶*
 - If you have ever had a **bad reaction** to any of the ingredients. *For the list of ingredients see section 6 ▶*
- **Speak to your doctor:**
 - If you suffer from any of the conditions mentioned in section 2. *See section 2 ▶*
- **Follow the dosage instructions carefully.** These are shown in the table. *See section 3 ▶*

Now read this whole leaflet carefully before you use this medicine. Keep the leaflet: you might need it again.

1 What the medicine is for

Sudafed Blocked Nose Spray is a medicine which is used to help clear the stuffy, blocked up feeling in your nose and sinuses caused by colds and allergies such as hay fever.

The spray contains xylometazoline hydrochloride, which is a topical decongestant that relieves nasal and sinus congestion.

This medicine is for use in adults and children aged 12 years and over.

2 Before taking this medicine

This medicine is suitable for most people but a few people should not use it. If you are in any doubt, talk to your doctor or pharmacist.

X Do not use this medicine...

- If you have ever had a **bad reaction** (e.g. rash, swelling of the face and throat, difficulty breathing) to any of the ingredients.
- If you are taking, or have taken in the last two weeks, **drugs for depression** known as Monoamine Oxidase Inhibitors (MAOIs).
- If you have recently had **neurosurgery**.
- If you have had your **pituitary gland** removed.
- For a child under 12 years old.

If any of these apply to you, **get advice from a doctor or pharmacist without taking Sudafed Blocked Nose Spray.**

! Talk to your doctor or pharmacist...

- If you have **high blood pressure** or **heart disease**.
- If you have **diabetes**.
- If you have an **overactive thyroid gland**.
- If you suffer from a **heart disease** (e.g. long QT syndrome)

If any of these bullet points apply to you now or in the past, **talk to a doctor or pharmacist.**

! If you are pregnant or breast-feeding

- If you are pregnant, or breast-feeding, think you may be pregnant or are planning to have a baby, ask your doctor or pharmacist for advice before taking this medicine.

! Some of the ingredients can cause problems

- Benzalkonium chloride is an irritant which may cause skin reactions.

3 How to use this medicine

Follow the instructions and study the pictures below to ensure that you use Sudafed Blocked Nose Spray correctly:

- **Step 1.** Remove the plastic cap from the nozzle.
- **Step 2.** When using the spray for the first time, press the plunger downwards while supporting the base with your thumb as shown in the diagram and release until a single spray is delivered.

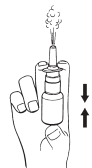
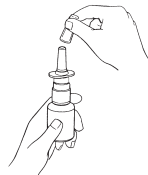

- **Step 3.** Hold the bottle upright and place the nozzle into one nostril. Press the plunger downwards and at the same time breathe in through your nose. Release the plunger and remove the nozzle from the nostril. Repeat this process for the other nostril.

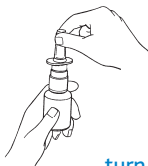

- **Step 4.** Wipe the nozzle and replace the plastic cap after use.

turn over ▶

Check the table that follows to see how much medicine to use.

- Do not use more than the stated dose shown in the table.

i Children under 12 years

Do not give to children under 12 years old.

i Adults and Children aged 12 years and over

Age	Dose
Adults and children aged 12 years and over	One spray into each nostril 2 to 3 times a day

- Do not take more than 3 doses in 24 hours.
- Do not use continuously for more than 7 days.
- If symptoms persist or worsen, talk to your doctor or pharmacist.

! If anyone has too much

If anyone has too much contact a doctor or your nearest Accident & Emergency Department (Casualty) taking this leaflet and pack with you.

! If you forget to take the medicine

If you forget to take a dose, take the next dose when needed provided that you do not take more than 3 doses in 24 hours.

Do not take a double dose.

4 Possible side-effects

Like all medicines, Sudafed Blocked Nose Spray can have side-effects, although not everybody gets them.

- Occasionally people may experience local irritation such as burning, soreness, dryness, stinging, itching or sneezing.
- Nausea and headache may rarely occur.
- If this medicine is used continuously for long periods, congestion symptoms may return.

Reporting of side-effects

If you get any side-effects, talk to your doctor, pharmacist or nurse. This includes any possible side effects not listed in this leaflet. You can also report side-effects directly via the Yellow Card Scheme at www.mhra.gov.uk/yellowcard.

By reporting side-effects you can help provide more information on the safety of this medicine.

5 Storing this medicine

Do not store above 25°C.

Keep the product out of the sight and reach of children.

Do not use your medicine after the end of the month shown as an expiry date on the packaging.

Medicines should not be disposed of via wastewater or household waste. Ask your pharmacist how to dispose of medicines no longer required. These measures will help to protect the environment.

6 Further information

What's in this medicine?

The active ingredient in Sudafed Blocked Nose Spray is: Xylometazoline hydrochloride 0.1% w/v.

Other ingredients are: Benzalkonium chloride, disodium edetate, sodium dihydrogen phosphate, sodium monohydrogen phosphate, sodium chloride, sorbitol solution, purified water.

What the medicine looks like

Sudafed Blocked Nose Spray is a clear colourless solution in a 15 ml bottle.

Marketing Authorisation holder: McNeil Products Ltd, Maidenhead, Berkshire, SL6 3UG, UK.

Manufacturer: Famar Orléans, 5 avenue de Concyr, 45071 Orleans, Cedex 2, France.

This leaflet was revised January 2019.

Sudafed is a registered trade mark.

